

Procedure Card

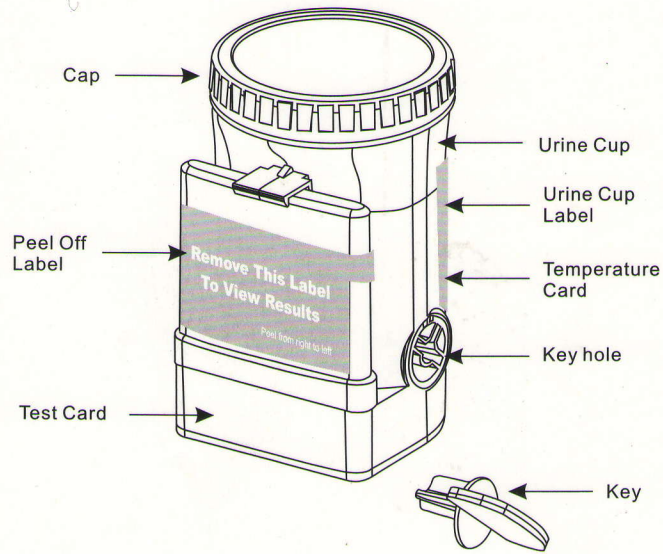

1

The donors collect their urine samples.
(Key is held by technician.)

Note:
The minimum sample volume is 25mL (See the Minimum Fill Volume scale on the cup label).

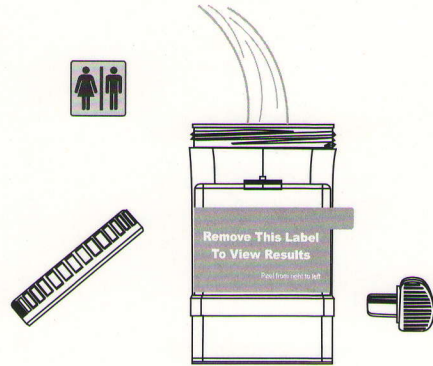

2

The technician check cap for tight seal and observe the temperature indicator card attached on the cup, dates the security seal label and place it over the cap.

Security seal label

Date _____	Initial _____	Security Seal				
READ	90	92	94	96	98	100
GREEN	<input type="checkbox"/>	<input type="checkbox"/>	<input type="checkbox"/>	<input type="checkbox"/>	<input type="checkbox"/>	<input type="checkbox"/>
COLOR	32	33	34	35	36	37

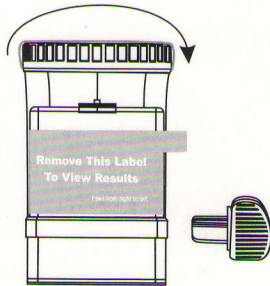

3

Insert the screw key to the key hole, then twists screw key from left to right till to a full position at one time.

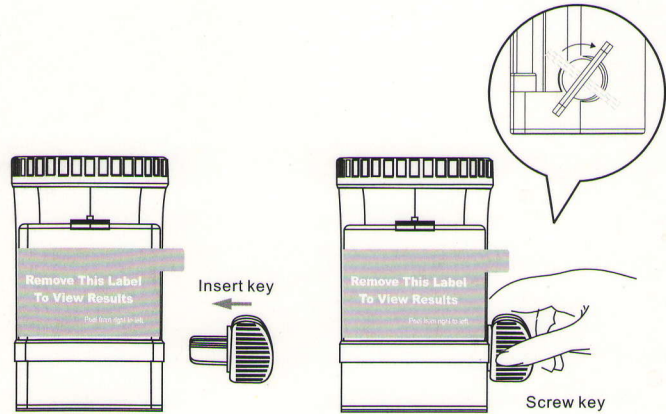

4

Wait for 5 minutes, remove the label and read the result.
Do not read results after 5 minutes.

